

Case Study

O'Carolan College Nobber, Co. Meath

Developer: Louth & Meath Education & Training Board

Contractor: Ganson Building and Civil Engineering Ltd

Architect: Oppermann and Associates

Civil & Structural Engineer: Downes Associates Ltd

Sector: Educational

Region: Leinster

Year of Completion: 2025



This transformative education project encompassed the full redevelopment of O' Carolan College, a prominent secondary school in rural Meath. The new facility is designed to offer cutting-edge learning environments that will serve students for generations to come.

Kilsaran Precast was awarded the contract to design, manufacture, deliver and install loadbearing and self-supporting walls, partition walls, floors and stairs for this project. Kilsaran also provided all the Ready-Mix Concrete, Concrete Blocks, Aggregates and Masonry Mortar. In addition to meeting structural requirements, the internal surface of the walls needed to be suitable for direct painting, and the external surfaces had to be prepared for the direct application of insulation boards. Furthermore, electrical conduits and boxes were embedded within the walls, and the openings for windows and doors needed to be ready for fitting.

Kilsaran Precast adopted a Just-in-Time delivery strategy, ensuring that precast components were manufactured and delivered in alignment with the project's rapid-build goals. This strategy showcases commitment to sustainable construction practices by integrating logistical efficiency into the project execution.

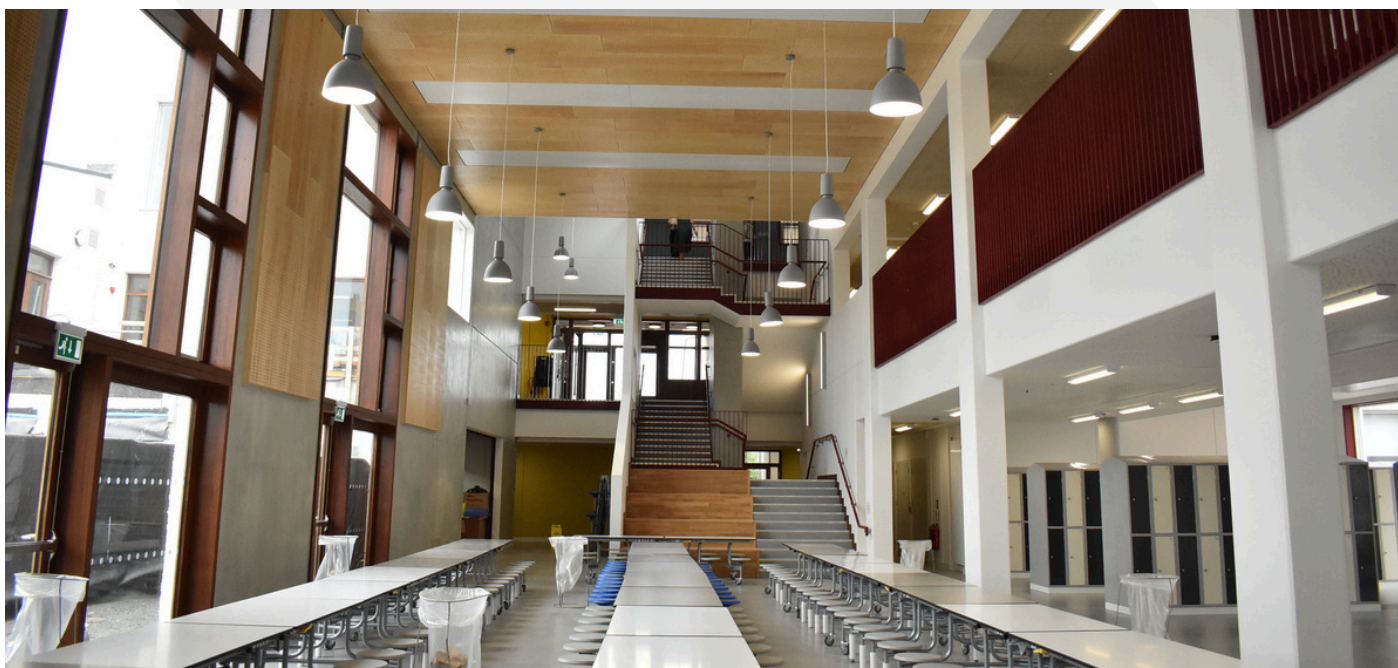

Kilsaran PRODUCTS

Precast:

- Twin Walls
- Solid Walls
- Hybrid Reinforced Slabs
- Stairs
- Columns
- Beams

Concrete Products & Aggregates:

- Ready-Mix Concrete
- Concrete Blocks
- Aggregates

KPRO:

- Masonry Mortar M4 - Off White
- Post 10